

Haiita

SPEED 10

ACTION CAMERA



USER MANUAL

V20231213

FCC COMPLIANCE STATEMENT

This device complies with Part 15 of the FCC Rules.

Operation is subject to the following conditions:

- (1) This device may not cause harmful interference
- (2) This device must accept any interference received, including interference that may cause undesired operation.

Please Note: This equipment has been tested and found to comply with the limits for a Class B digital device, pursuant to part 15 of the FCC Rules. These limits are designed to provide reasonable protection against harmful interference in a residential installation. This equipment generates uses and can radiate radio frequency energy and, if not installed and used in accordance with the instructions, may cause harmful interference to radio communications. However, there is no guarantee that interference will not occur in a particular installation. If this equipment does cause harmful interference to radio or television reception, which can be determined by turning the equipment off and on, the user is encouraged to try to correct the interference by one or more of the following measures:

- Reorient or relocate the receiving antenna.
- Increase the separation between the equipment and the receiver.
- Connect the equipment into an outlet on a circuit different from that to which the receiver is connected.

Contents

Important Messages-----	01
Your Camera -----	02
What's in the Box-----	04
Camera Specifications-----	05
Getting Started-----	05
1. First Use-----	05
2. Operation Instructions-----	07
3. Indicators -----	09
4. Memory Card Use-----	09
Video Menu-----	11
1. Video Modes -----	11
2. Video Settings -----	13
Photo Menu -----	17
1. Photo Modes-----	17
2. Photo Settings-----	18
System Settings-----	21
Connecting to the SupCam Pro APP-----	25
Playing Back Your Content -----	27
1. Playing Back Files on Your Haiita Speed 10-----	27
2. Deleting Files On Your Haiita Speed 10 -----	27

Contents

Offloading Your Content	28
1. Offloading Your Content to A Computer	28
2. Downloading Your Content to the Smartphone	28
Adjusting Zoom Levels.....	29
Reformatting Your Memory Card.....	30
Remote	30
Maintaining Your Camera	31
Battery Maintenance	32
Mounting Your Camera.....	34

Important Messages

Congratulations on your new **Haiita Speed 10!** You must be excited to use your new camera, but please spend some time familiarizing yourself with this manual first so that you get the most out of your camera's features.

- 1.This camera is a precision product, so please handle it with care to avoid any mishaps or damage caused by falling or collisions.
- 2.Keep this camera away from machines or objects that generate strong magnetic fields or power, such as motors or magnets, as they may interfere with its proper functioning.
- 3.Ensure that the camera operates within its recommended temperature range. Avoid exposing it to high or low-temperature environments for extended periods of time, as this could potentially shorten its lifespan.
- 4.Before diving, securely attach the action camera to the waterproof case to prevent water leakage and subsequent malfunction.
- 5.Do not overcharge the battery for an extended period of time. Additionally, keep it out of reach of children and pets to prevent any potential accidents.
- 6.If you do not intend to use the camera for a prolonged period, remember to remove the battery to preserve its longevity.
- 7.Store this camera in a safe place, away from sharp metal objects and damp areas that could potentially cause damage.



Warm Tip: In case your camera does not work normally or encounters any issue, please feel free to contact customer support for help by sending emails to our official email address **support@haiitacam.com**.

YOUR CAMERA

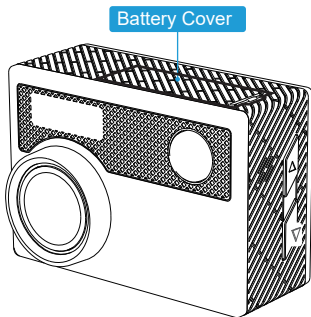

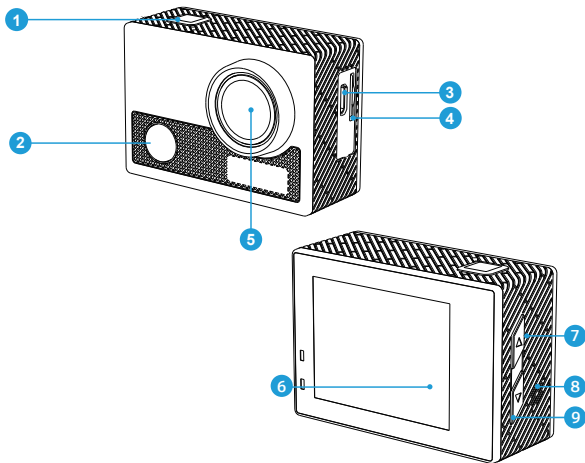

- | | |
|---------------------|------------------|
| 1 OK/Shutter | 6 Display Screen |
| 2 Power/Mode Button | 7 Up |
| 3 Type-C Port | 8 Speaker |
| 4 SD Card Slot | 9 Down |
| 5 Lens | |

Note: The camera will not record sound when it is in the waterproof case.



What's in the Box



SPEED 10
x 1



Waterproof
Case x 1



Battery Charger
x 1



Battery
x 2



USB Cable
x 1



Remote Control
x 1



Remote Control
Strap x 1



Protective
Backdoor x 1



Clip 1
x 1



Clip 2
x 1



Buckle Mount
x 1



J-Hook Mount
x 1



A Mount
x 1



C Mount
x 1



D Mount
x 1



F Mount
x 1



E Mount
x 1



H Mount
x 1



Helmet Mount
x 2



Spanner
x 1



Bandage
x 4



Tether
x 5



Lens Cloth
x 1



Double-Sided
Adhesive Tape x 2



User Manual
x 1



Camera specifications

Model	Speed 10
Lens	140°HD wide-angle fish-eye lens
APP	SupCam Pro
Screen	2" Screen
Picture Format	JPG
Video Format	MP4
Memory Card	Support 64-256GB U3 Micro SD Card
Video Code	H.264
Battery	2x1350mAh Batteries
Recommend Resolution	Video: 4K30FPS/Picture: 12MP
Speaker	Built-in
Microphone	Internal & External
Connections	Type-C
WiFi	Built-in 2.4G
Working Temperature	-50°F(-10°C)~+122°F(50°C)
Storage Temperature	-50°F(-10°C)~+158°F(70°C)
Operating System	Windows XP/7/8,SP3/Vista and Mac 10.5 or above

GETTING STARTED

1. First Use



1.1 Charge the camera

Insert the battery into the battery slot, then connect the camera to a USB adapter or computer using the USB cable. Once fully charged, disconnect the cable and ensure the battery cover is securely fastened.

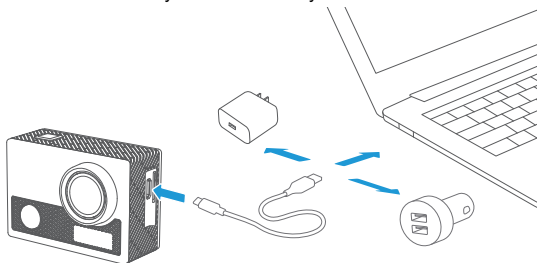

1.2 Install the micro SD card

Insert the memory card in the orientation shown.

Note: Be sure to turn off the camera before installation.

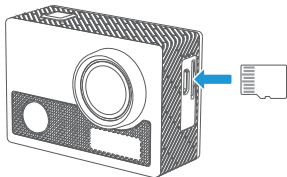

1.3 Power on the camera

Press and hold the **Power** button for 3 seconds to turn on the **Haiita Speed**

10. Ensure all the camera covers are securely closed before powering it on.

2. Operation Instructions

2.1 Powering on or off

While the camera is off, press and hold the **Power** button for 3 seconds to turn it on.

While the camera is on, press and hold the **Power** button for 3 seconds to turn it off.

2.2 Switching shooting modes

On the preview screen, you can short-press the **Power/Mode** button to switch modes.

Tip: To exit the mode menu, please press the **Power/Mode** button once.

There are 9 modes of this action camera: Normal Video, Slow Video, Loop Video, Timelapse Video, Normal Photo, Auto Timer Photo, Burst Photo, Timelapse Photo and WiFi.

2.3 Zooming in or out

On the preview screen, long press and hold **Up** or **Down** to zoom in or out, support Up to 5X.

2.4 Using the shutter button

In Photo or Video mode, press the **Shutter** button to capture photos or start



Video recording.

To stop recording in Video mode, press the **Shutter** button again.

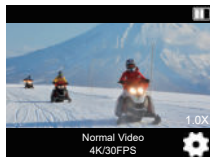

2.5 Entering the settings screen

On the preview screen, press and hold the **OK** button to enter the settings screen. Then, press **Mode** button to configure the photo or video and system settings as you wish.

2.6 Entering the playback screen

On the preview screen, press the **Down** button to enter the playback screen. You will be able to access the video or the photo set to playback or delete files. To exit the playback screen, simply press the **Mode** button.

2.7 Turning WiFi On or Off



Turning on WiFi

Quick Entry: When the camera is turned on, press **Up** button to turn on WiFi.

WiFi Mode Entry: To enter the mode page, press the **Mode** button. Next, use the **Down** button to navigate and select the desired mode. Once you locate the **WiFi** option, press the **OK** button to activate WiFi connectivity. The camera will enter WiFi mode and display the WiFi information in 3 seconds.

Turning off WiFi

In WiFi mode, press **Up** button or **Mode** button again to turn off WiFi.

3. Indicators

Charging Indicator (Red)

Stays on while charging, and goes out when fully charged.

Working Indicator (Blue)

Stays on when powering on, goes out when powering off, and flashes when capturing.

WiFi Indicator (Orange)

Flashes when WiFi is turned on, stays on when connected, and goes out when off.

4. Memory Card Use

To capture video or take photos, you will need a Micro SD card (sold



separately). Please use brand name memory cards that meet the following requirements:

(1) U3

(2) Capacity Up to 256GB (FAT32)

Micro SD Card Formatting

Warm tips:

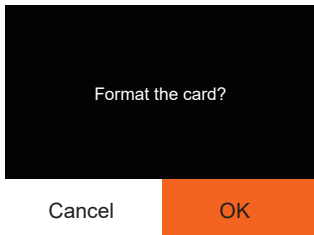

1. Please format the memory card in this camera before using it for better compatibility.

2. Memory cards larger than the specified maximum capacity can cause issues like non-recognition or even camera malfunctions like unresponsiveness or firmware failure.

3. To keep your memory card in good condition, regularly reformat your memory card for optimal performance. Remember, reformatting erases all data, so transfer your photos and videos before reformatting. With FAT32, the card will stop recording and create a new file if the file size of a recording



reaches 4GB.

Notes:

1. Be sure to turn off the camera before installation or removal.
2. Insert the card into the card slot with the correct orientation.
3. Avoid using the card in areas with strong currents or magnetic fields.
4. Refrain from allowing the card to come into contact with metal objects, and avoid using any metal tools that could cause it to be squeezed, bent, or fall.
5. Store the card in dry locations, away from corrosive substances.
6. Always ensure that no foreign items are inserted into the card slot.

In Video/Photo Preview Interface

Video Menu

The camera is in Normal Video mode by default when it's turned on. Video modes of this camera include Normal Video, Slow Video, Loop Video and Timelapse Video.

1. Video Modes

(1) Normal Video Mode

In Video mode, press the **Shutter** button to record video in the set resolution. On the preview screen, long press and hold **Up** or **Down** to zoom in or out, support Up to **5X**.



Tip: You can also enter the video mode menu to enable Video mode.

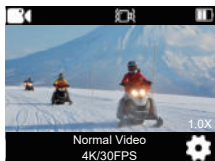

(2) Slow Video Mode

To enter Slow Video mode, short-press the **Power/Mode** button to enter the modes selection interface to choose **Slow Video**. Lastly, go back to the preview screen.

In this mode, press the **Shutter** button to record a slow-motion video at the set resolution and speed. On the preview screen, long press and hold **Up** or **Down** to zoom in or out, support Up to **5X**.

Before recording slow videos, you can enter the video settings screen to configure the resolution and speed.

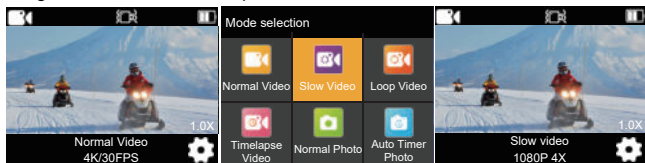

(3) Loop Video Mode

To enter Loop Video mode, short-press the **Power/Mode** button to enter the modes selection interface to choose **Loop Video**. Lastly, go back to the

preview screen.

In this mode, press the **Shutter** button to record a loop video of the set length.

On the preview screen, long press and hold **Up** or **Down** to zoom in or out, support Up to **5X**.

Before recording loop videos, you can enter the video settings screen to configure the resolution and Video Length.

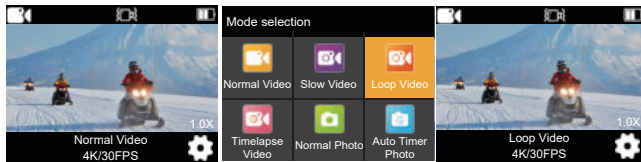

(4) Timelapse Video Mode

To enter Timelapse Video mode, short-press the **Power/Mode** button to enter the modes selection interface to choose **Timelapse Video**.

In this mode, press the "Shutter" button to capture a series of videos at the set interval. On the preview screen, long press and hold **Up** or **Down** to zoom in or out, support Up to **5X**.

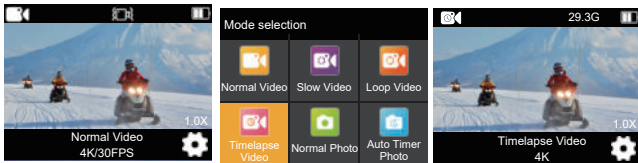

2.Video Settings

(1) Video Resolution:

5K 30FPS/4K 60FPS/4K 30FPS/2.7K 60FPS/2.7K 30FPS/1080P 60FPS/
1080P 30FPS/720P 120FPS/720P 60FPS/720P 30FPS (Default setting: **4K
30FPS**)

This camera is capable of recording video Up to 5K30FPS, with higher resolution offering greater clarity and detail due to the increased number of pixels. However, higher resolution video also results in larger file sizes. Capturing high-resolution or high-fps videos in warmer conditions may consume more power.

(2) Video Mode:

You can choose the video mode you want from the available options.

- **Normal Video:** In this mode, press the **Shutter** button to record normal videos. To stop recording, simply press the **Shutter** button again.
- **Slow Video:** 2.7K 2X /1080P 4X /1080P 2X / 720P 8X / 720P 4X

Slow Video mode allows the camera record videos at the set resolution and slow motion speed. However, the video footage will be saved at a playback speed of 30 frames per second (**FPS**). As a result, when the video is played back, it will appear to be slowed Down, creating a visually captivating effect.

- **Loop Video:** 1Min / 2Min / 3Min / 5Min (Default setting: **2Min**)

In Loop Video mode, if you set **Video length** to **3Min**, the camera will record a video and save the content every 3 minutes. When the memory is full, new video files will overwrite the old ones to ensure continuous recording.



- **Timelapse Video:** 1S / 2S / 5S / 10S / 30S / 60S (Default setting: **1S**)

This option enables you to specify the frequency at which the video frames are captured and compiled. The camera will capture a series of videos at the set interval, making it ideal for taking photos in dynamic or changing scenes, such as clouds, stars, sunsets, and more.

Note:

- ① Timelapse Videos are captured without audio.
- ② Timelapse Interval is available only in Timelapse Video mode.

(3) EIS

Off / On (Default setting: **On**)

4K 60FPS/4K 30FPS/2.7K 60FPS/2.7K 30FPS/1080P 60FPS/1080P 30FPS/
720P 60FPS/720P 30FPS

Note:

- ① 5K 30FPS and 720P 120FPS are not available in EIS mode. Electronic Image Stabilization (**EIS**) 2.0 effectively corrects the lens distortion, allowing for smooth videos. This feature is suitable for use in riding, skiing, and handheld scenes.
- ② Electronic Image Stabilization is not available in Slow Motion and Timelapse Video modes.

(4) Motion Detection



Off / On (Default setting: **Off**)

The Motion Detection feature allows the camera to sense movement and automatically start recording video. This process involves the camera detecting the motion of an object in its field of view, or the motion of the surroundings relative to the object.

When Motion Detection is enabled, the camera will automatically start recording video when it detects any movement within its field of view.

(5) Exposure Value (EV)

-3 / -2 / -1 / 0 / 1 / 2 / 3 (Default setting: **0**)

By default, your camera uses the entire image to determine the appropriate exposure level. However, Exposure lets you select an area that you want the camera to prioritize when determining exposure. This setting is particularly useful in shots where an important region might otherwise be over-or underexposed.

The camera will display changes in the image the instant you change the setting. It will resume using the entire image to determine the appropriate exposure level if you switch modes.

(6) Date Stamp

Off / On (Default setting: **On**)

With Date Stamp enabled, a time and date watermark will be added to the



video. You can also set it to Off.

(7) Metering

Average / Center / Spot (Default setting: **Average**)

Choose the metering mode from the available options to optimize your shot based on different scenes.

- **Average Metering:** Sometimes referred to as matrix metering, this mode evaluates the entire scene's brightness, ensuring well-balanced exposure and avoiding overexposure, especially in evenly lit settings.
- **Center Metering:** Emphasizes the scene's center, making it ideal for selfies or close-up shots, like flowers.
- **Spot Metering:** Targets a specific spot in the scene to determine exposure, perfect for detailed close-Ups.

(8) Video Quality

High / Middle / Low (Default setting: **Middle**)

Determine the image quality of your videos. A higher Video Quality setting directly translates to better image quality, but often accompanied by larger file sizes.

Photo Menu

1.Photo Modes

Photo modes of this camera include Normal Photo, Auto Timer Photo, Burst



Photo and Timelapse photo.

2. Photo Settings

(1) Normal Photo

64MP/56MP / 50MP / 30MP/24MP/ 20MP/12MP / 8MP (Default setting: **12MP**)

This camera is capable of capturing 64MP photos, with higher resolution offering greater clarity and detail due to the increased number of pixels.

However, higher resolution photo also results in larger file sizes.

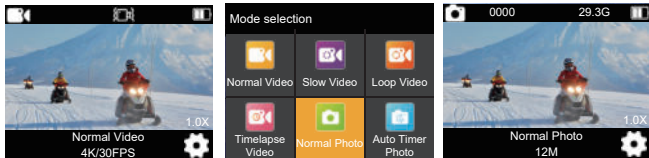

(2) Auto Timer Photo

3S / 5S / 10S / 15S / 20S (Default setting: **3S**)

The camera captures a series of photos at the set interval, making it ideal for taking photos in dynamic or changing scenes, such as clouds, stars, sunsets, and more.

Note: Timelapse Interval is available only in Auto Timer Photo mode.

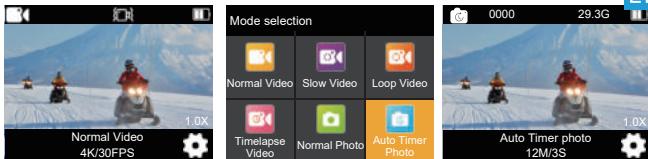

(3) Burst Photo

3P/S, 5P/S (Default setting: **3P/S**)

Set the number of photos to be taken per second in Burst Photo mode. The camera will continuously take multiple photos at the specific shot.

Note: Burst Photo is available only in Burst Photo mode.

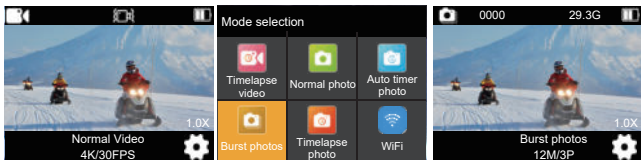

(4) Timelapse Photo

3S / 5S / 10S / 15S / 20S / 30S (Default setting: **3S**)

Set the **CountDown** before the camera takes a photo in Timer Photo mode. For instance, if you set the **CountDown** to **3S**, the camera will Count Down from 3 to 1 before capturing the shot.

Note: CountDown is available only in Timelapse Photo mode.

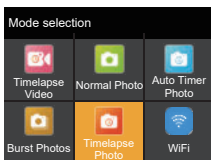
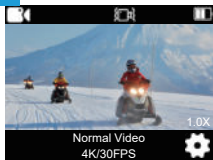

(5) Exposure Value (EV)

-3 / -2 / -1 / 0 / 1 / 2 / 3 (Default setting: **0**)

By default, your camera uses the entire image to determine the appropriate exposure level. However, Exposure lets you select an area that you want the camera to prioritize when determining exposure. This setting is particularly useful in shots where an important region might otherwise be overexposed.

The camera will display changes in the image the instant you change the setting. It will resume using the entire image to determine the appropriate exposure level if you switch modes.

(6) Metering

Average / Center / Spot (Default setting: **Average**)

Choose the metering mode from the available options to optimize your shot based on different scenes.

- **Average Metering:** Sometimes referred to as matrix metering, this mode evaluates the entire scene's brightness, ensuring well-balanced exposure and

avoiding overexposure, especially in evenly lit settings.

- **Center Metering:** Emphasizes the scene's center, making it ideal for selfies or close-Up shots, like flowers.
- **Spot Metering:** Targets a specific spot in the scene to determine exposure, perfect for detailed close-Ups.

(7) ISO

Auto / 100 / 200 / 400 / 800 / 1600 / 3200 (Default setting: **Auto**)

ISO determines the camera's sensitivity to light and creates a trade-off between brightness and resulting image noise. Image noise refers to the degree of graininess in the image. In low light, higher ISO values result in brighter images, but with greater image noise. Lower values result in lower image noise, but darker images.

(8) Time Stamp

Off / On (Default setting: **On**)

With Date Stamp enabled, a time and date watermark will be added to the photo. You can also set it to Off.

System Settings

In Video or Photo mode, long press **OK** button to enter the system settings



screen.

Press the **Mode** button to switch to the system settings page.

(1) Image rotation

Off / On (Default setting: **Off**)

This setting determines the orientation of the image in videos or photos, preventing the camera from recording videos with Upside-Down images.

Note: The user interface will be Upside-Down when Upside Down is enabled.

(2) Screen brightness

High / Middle / Low (Default setting: **Middle**)

You can choose from these options to get a Screen Brightness result.

(3) Anti-flicker

50HZ / 60HZ (Default setting: **50HZ**)

Anti-flicker is also known as the line frequency or mains frequency, it is the frequency of the alternating current (**AC**) that is used in most electrical power systems around the world. If you live in the northeastern area, please set the power frequency to 60Hz, meaning the current changes direction 60 times per second. If you live outside this area, set it to 50Hz.

(4) Angle

Wide/ Middle / Narrow (Default setting: **Wide**)

Wide Dynamic Range (Wide Range retains a greater level of details in the dark



and bright areas of an image. The result is that a photo is properly exposed in the two extremes.

Wide Range is ideal for use in high-contrast scenes. Wide Range is available only in Video mode.

(5) Car mode

Off / On (Default setting: **Off**)

When Car Mode is enabled, the camera can compensate for the absence of red light in underwater scenes. This mode is ideal for use in tropical and blue waters.

Frequency of the alternating current (**AC**) that is used in most electrical power systems around the world. If you live in the northeastern area, please set the power frequency to 60Hz, meaning the current changes direction 60 times per second. If you live outside this area, set it to 50Hz.

(6) language

English/Deutsch/Français/Español/Italiano/日本語/한국어/繁体中文/简体中文
(Default setting: English)

You can set the camera's system language.

(7) Date & Time setting

YYYY / MM / DD

You can manually set the date and time for your camera. The camera's date



and time will sync with that of your phone once it's connected to the app. This ensures that your camera's time stamps are accurate and aligned with your local time zone.

Note: The camera's date and time will reset automatically after the battery is removed.

(8) Screen saver

Close / 30S/ 1Min / 2Min (Default setting: **2Min**)

The display will be turned off automatically after a period of inactivity to save battery life. To turn on the display again, press any button on the camera.

(9)Automatic shut-Down

Close / 3Min / 5Min / 10Min (Default setting: **Close**)

The camera will power off after a period of inactivity to save battery life.

(10) Format

Yes / No (Default setting: **No**)

Format your memory card in the camera before using it for the first time. To keep your memory card in good condition, please reformat it on a regular basis.

Reformatting erases all of your content, so be sure to offload your photos and videos first.

(11) Factory Reset

Yes / No (Default setting: **No**)

This option will reset all settings to the default values.

Connecting to the **SupCam Pro** App

To connect your camera to the **SupCam Pro** app, please Download this app from the App Store or Google Play to your smartphone first. When your camera is connected to the **SupCam Pro** app, you can control it to capture, or change its settings using your phone. You can also live preview, playback, Download, edit, and share videos via this app. Please follow the instructions below to connect your camera to the **SupCam Pro** app.

Scan Me



1. **Quick Entry:** When the camera is turned on, press **Up** button to turn on WiFi.

WiFi Mode Entry: To enter the mode page, press the **Mode** button. Next, use the **Down** button to navigate and select the desired mode. Once you locate the **WiFi** option, press the **OK** button to activate WiFi connectivity.

The camera will enter WiFi mode and display the WiFi information in 3 seconds.

2. Enter your phone's WiFi settings page, find the WiFi SSID in the list and tap on it, then enter the password: **12345678** for connection.

Warm tip: Once the camera WiFi is connected, it will give you a **No Internet Connection** or **Weak Security** notice since your phone's 4G signal is blocked. You can ignore it and continue the app connection; The screenshots provided are for your reference only.

3. Open the **SupCam Pro** app, tap **Enter Preview** → **Set Wi-Fi connection**, then select **Haiitacam_xxxxxx** from the list and enter the password **12345678** to establish a connection.

4. Return to the app and tap on **Enter Preview**. Your camera will be seamlessly connected to the SupCam Pro app within seconds.

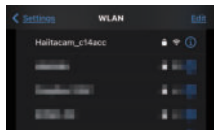

Playing Back Your Content

You can play back your contents on the camera, your computer, TV, or smartphone.

To play back your videos and photos on a computer, you need to transfer these files first. Transferring files also frees Up space on your memory for new contents.

With this method, the playback resolution depends on the resolution of the device and its ability to play back that resolution.

1. Playing Back Files on Your Haiita Speed 10

- (1) Turn on your Haiita Speed 10.
- (2) Press the **Down** button to enter the play screen.
- (3) Press the **Up** or **Down** button to select the photos or videos mode and then press the **OK** button to enter the selected mode.
- (4) Press the **Up** or **Down** button to select a photo or video to play photo or video to play.
- (5) Press the **OK** button photo or video to play it back in full screen.

Note: If your memory card contains a lot of content, it might take a minute to load.

2. Deleting files on Your Haiita Speed 10

- (1) Press the **Down** button to enter the play screen.
- (2) Press the **Up** or **Down** button to access photos or videos.



- (3) Press the **Up** or **Down** button to select a photo or video to play photo or video to play.
- (4) Press the **OK** button photo or video to select the photo or video you want to delete.
- (5) Long press **OK** button, press the **Up** or **Down** button to select **Delete the current file**, **Delete all files** and **cancel**.
- (6) Press **OK** button the chosen file will be deleted.

Offloading Your Content

1. Offloading Your Content to A Computer

You can transfer your content to a computer via a USB cable or a card reader (sold separately). To transfer files to your computer via a USB cable, connect your camera to the computer's USB port using the USB cable. When prompted, select "USB Storage" as your connection preference. To transfer files to the computer using a card reader, insert a memory card into the card reader, then connect the reader to your computer's USB port. After successful transmission, you can transfer the files to your computer or delete selected files using File Explorer.

2. Downloading Your Content to the Smartphone

- (1) Open the **SupCam Pro** app, then connect it to your camera.
- (2) Tap the **Enter Preview**, then tap the **album icon** to view all the photos and videos taken by the camera.
- (3) Select the **Download** icon on the bottom right corner after choosing the



desired video or photo using the **Select** icon on the top right corner of the application interface. Please wait patiently until the download process completes. Your file will be saved successfully in **Local album** of app.

Note:

- ① Please do not alter WiFi settings or disconnect from the app during the Download progress.
- ② If you cannot Download videos or photos to your iPhone via the app, please enter, your phone's **Settings** page→**Privacy & Security**→**Cameras**, find "**SupCam Pro**", and select Enable(The enabled state will be indicated by a green button).

Adjusting Zoom Levels

The Zoom function lets you adjust how close or far away the subject. The Zoom function lets you adjust how close or far away the subject appears in your photo. The default is no zoom. The zoom feature is available in all shooting modes. Haiita Speed 10 can zoom Up to **5X**. Please follow the instructions below to use the zoom function.

- (1) Turn on the Haiita Speed 10.
- (2) Enter any of the capture modes.
- (3) Long press and hold **Up** or **Down** to zoom in or out.



Reformatting Your Memory Card

To keep your memory card in a good condition, reformat it on a regular basis. Reformatting erases all of your content, so be sure to offload your photos and videos first.

- (1) Press and hold the **Power/Mode** button to turn on your Haiita Speed 10.
- (2) Long press **OK** button bottom to enter the system settings screen.
- (3) Press the **Mode** button to switch to the system settings page and press the **Down** button to find the **Format** option, then select it.
- (4) The screen shows **Format the card? Cancel/OK**.
- (5) Select **OK**, the Press **OK** button, the screen shows **SD card formatting...**, and **Formatting SD Card completed!** Then you format your memory card successfully.

Remote

When the camera is turned on, it will be automatically connected to the remote within a certain distance. You can control the camera to take photos or record videos using the remote.

Splashproof only,
not waterproof



Photo Button

Video Button



Video

To record video, first make sure the camera is in Video mode.

To start recording, simply press the **Gray Video** button. The camera will emit one beep with the working indicator light flashing.

To stop recording, simply press the **Gray Video** button again. The camera will emit one beep with the working indicator light turned off.

Photo

To capture a photo, first make sure the camera is in Photo mode, then press the **Red Photo** button. The camera will emit a shutter sound indicating the completion of the shot.

Burst Photo

To capture burst photos, first verify the camera is in Burst Photo mode, then press the **Red Photo** button.

Time Lapse

To capture time lapse photos or videos, first verify the camera is in Time Lapse mode, then press the **Red Photo** or **Gray Video** button.

Maintaining Your Camera

Follow these guidelines to get the best performance from your camera:

(1) For best audio performance, shake the camera or blow on the mic to



remove debris from the microphone holes.

(2) To clean the lens, wipe it with a soft, lint-free cloth. Do not insert foreign objects around the lens.

(3) Don't touch the lens with fingers.

(4) Keep the camera away from drops and bumps, which may cause damage to the parts inside.

(5) Keep the camera away from high temperature and strong sunshine to avoid being damaged.

Battery Maintenance

1. Maximizing Battery Life

If the battery reaches **0%** while recording, the camera saves the file and powers off.

To maximize battery life, follow these guidelines when possible:

(1) Fully charge the battery and put it into the battery slot for capturing when you use the Haiita Speed 10 for the first time.

(2) Capture at lower resolutions frame rates.

(3) Use the Screen Saver setting.

(4) We recommend you replace the battery every year for better performance.

2. Battery Handling and Storage



1. Please leave the lithium battery stored with the remaining battery of **50-60%** if not using it for a long period of time. And we recommend you charge the battery every **3** months and discharge it every **6** months.
2. Please do not store the battery with metal objects such as coins, buttons, or necklaces. If the battery terminals come close to metal objects, fire may be caused due to a short circuit.
3. Keep the battery away from wet or moist places, and protect it from damage caused by squeezing or collision.
4. Please do not use or store the battery in high temperatures, such as in direct sunlight or a hot compartment. The battery will heat Up, malfunction, or have its service life shortened in these conditions.
5. Please do not use or store the battery in low-temperature environments as this will shorten the battery life or cause malfunction to the battery.
6. Please do not put the battery in any places with strong static and magnetic fields, otherwise, the battery protection unit is likely to be destroyed, which causes safety risks.
7. Please stop using the battery and remove the battery from the camera or the battery charger at once if it stinks, heats Up, discolors, distorts, or if there is anything wrong with the battery while working, charging, or in store.
8. Please wrap Up the obsolete electrode with insulation paper in case of fire or explosion.
9. Please do not throw the battery into the fire in case of an explosion.



Mounting Your Camera





=



+



+



=



+



=



+



=



+



=



+



+



=



+

Contact Us



support@haiitacam.com



@HaiitaCam



@HaiitaCam



@HaiitaCam

For any questions about the product, you can always contact us through the official website  www.haiitacam.com. We will respond within 24 hour.